

Soils Map

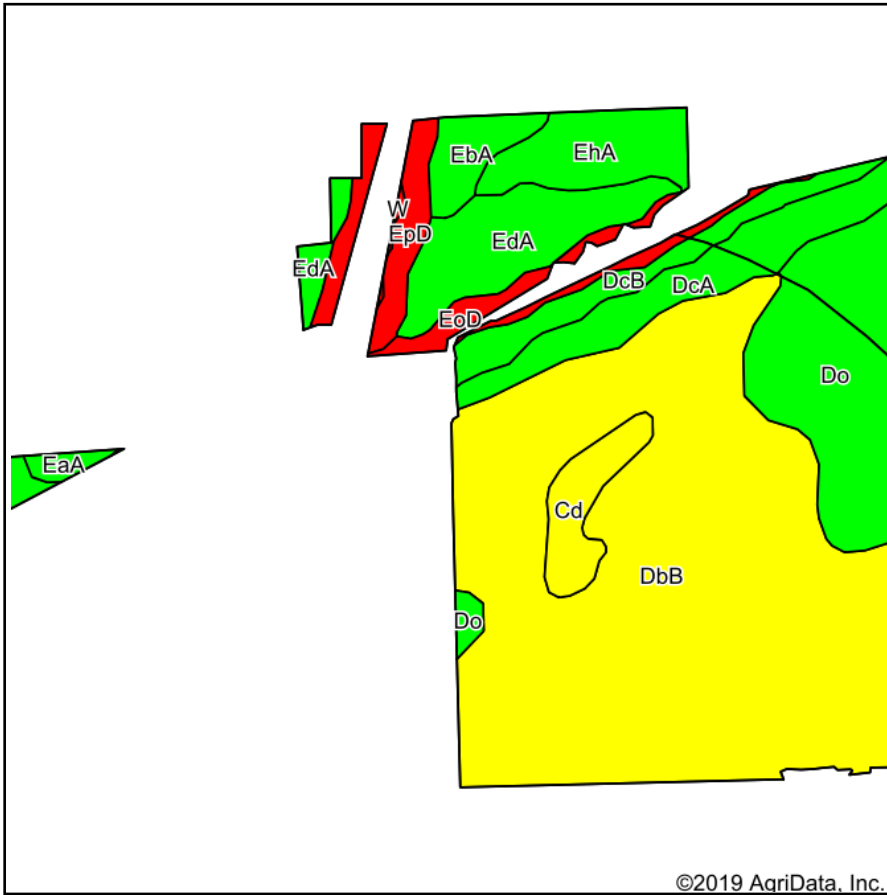

Soils data provided by USDA and NRCS.

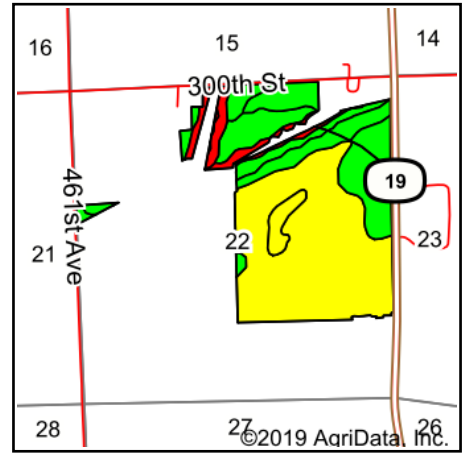

State: **South Dakota**
 County: **Clay**
 Location: **22-95N-52W**
 Township: **Riverside**
 Acres: **229.19**
 Date: **9/22/2019**



Maps Provided By:



Area Symbol: SD027. Soil Area Version: 21						
Code	Soil Description	Acres	Percent of field	PI Legend	Non-Irr Class *c	Productivity Index
DbB	Dalesburg-Dimo complex, 1 to 4 percent slopes	124.34	54.3%		Ile	68
Do	Dimo clay loam, 0 to 2 percent slopes	27.50	12.0%		IIs	74
EdA	Egan-Clarno-Trent complex, 0 to 2 percent slopes	17.84	7.8%		Iw	90
DcA	Davis loam, 0 to 2 percent slopes	14.25	6.2%		Iw	90
EhA	Egan-Trent silty clay loams, 0 to 2 percent slopes	10.40	4.5%		Iw	93
DcB	Davis loam, 2 to 6 percent slopes	8.43	3.7%		Ile	87
EpD	Ethan-Bon, channeled, loams, 0 to 20 percent slopes	7.62	3.3%		VIe	34
Cd	Clamo silty clay, 0 to 1 percent slopes	6.59	2.9%		IVw	61
EoD	Ethan-Betts loams, 9 to 15 percent slopes	5.60	2.4%		VIe	30
EbA	Egan-Clarno-Chancellor complex, 0 to 3 percent slopes	4.99	2.2%		Iw	88
EaA	Egan-Chancellor-Davison complex, 0 to 3 percent slopes	1.36	0.6%		Iw	84
W	Water	0.27	0.1%		VIII	0
Weighted Average						71.8

*c: Using Capabilities Class Dominant Condition Aggregation Method
 Soils data provided by USDA and NRCS.